

DA317/17 LGS:HP  
Environment & Development Dept.

7 February 2018

Hartley District Progress Association  
hartleyprogress@gmail.com

Dear Sir/Madam



**DA317/17 – PROPOSED TELECOMMUNICATIONS FACILITY - LOT 2 DP 1069254 - 2430  
GREAT WESTERN HIGHWAY LITTLE HARTLEY NSW 2790**

In regard to the above mentioned Development Application and to the previous notification letters, Council advises that the Development Application from M Stankovic C/- Aurecon Australasia Pty Ltd, identified the property to be Lot 4 DP 1192566, 2430 Great Western Highway, Little Hartley.

Council has received clarification from the applicant confirming that the development is proposed to be located on Lot 2 DP 1069254, 2430 Great Western Highway, Little Hartley.

The location of the proposed development was identified on the site plans that were attached to Council's previous notification letter dated 7 December 2017 and on the web link on Council's website.

As the property description on the application form has been amended, the application and plans are on display for an additional 14 day period until the 21 February 2018. The development application and plans are available for inspection at the Council's Environment & Development Department, in the Council Administration Centre, 180 Mort Street, Lithgow, free of charge, during office hours.

Attached for your reference is a copy of the site plan and elevation plan for the proposed development. There has been no change to the site, but given the applicant referenced Lot 4 DP 1192566 rather than Lot 2 DP 1069254 an additional period will be provided for comment.

Please note that previous submissions in relation to this DA will be taken into consideration during the assessment process.

Under the Environmental Planning Assessment Act, a person who makes a *public submission* to Council in relation to a development application is required to disclose the reportable political donations and/or gifts (if any) made by the person making the submission, or any *associate of that person*, within the period commencing 2 years before the submission is made and ending when the application is determined. A notice about this matter and the Disclosure Form that is to be included with any submission are available on the NSW Department of Planning & Environment web site under 'Donation and gift disclosure'.

Thank you for your participation in this process. The responsible officer dealing with this application is Lauren Stevens who is available between 8:15am-11:00am on 63549999 Monday to Friday in Council's Environment & Development Department.

**PRIVACY & PERSONAL INFORMATION PROTECTION NOTICE IN RELATION TO SUBMISSIONS & OBJECTIONS**

By making a submission to this plan Council may make public details of your submission, which are *not* of a personal nature. Should you not wish details of your submission to be disclosed you should include a clear statement to this effect in your submission. Under these circumstances Council will consider your request and may not publically release a copy.

Council will only consider the release of personal information in compliance with the Government Information (Public Access) Act 2009.

Yours sincerely

**L G Stevens**

DEVELOPMENT PLANNER

# SITE LOCATION

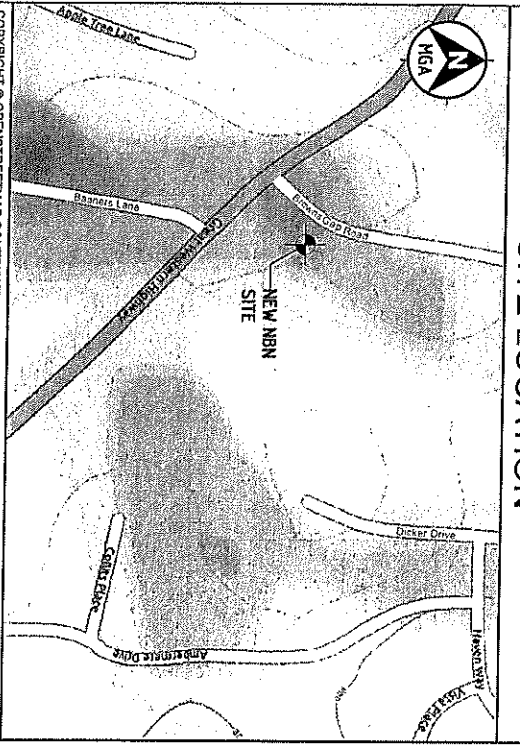

COPYRIGHT © OPENSTREETMAP CONTRIBUTORS, CC BY-SA  
 All rights reserved. No warranty is made by the contributors or OpenStreetMap Foundation for the use of the data. The data is provided as-is and the user assumes all liability for its use.

<b>SITE CO-ORDINATES</b>	
<b>MONOPOLE LOCATION</b>	
DATUM: MGA (GDA94)	ZONE: 56
LATITUDE	-33.56306°
LONGITUDE	150.20069°
EASTING	240134
NORTHING	6 282 778

## LEGEND

- A-E — EXISTING AERIAL ELECTRICAL ROUTE
- MAE — NEW AERIAL ELECTRICAL ROUTE
- — — — — PROPERTY BOUNDARY
- — — — — EXISTING UNDERGROUND TELSTRA SERVICES

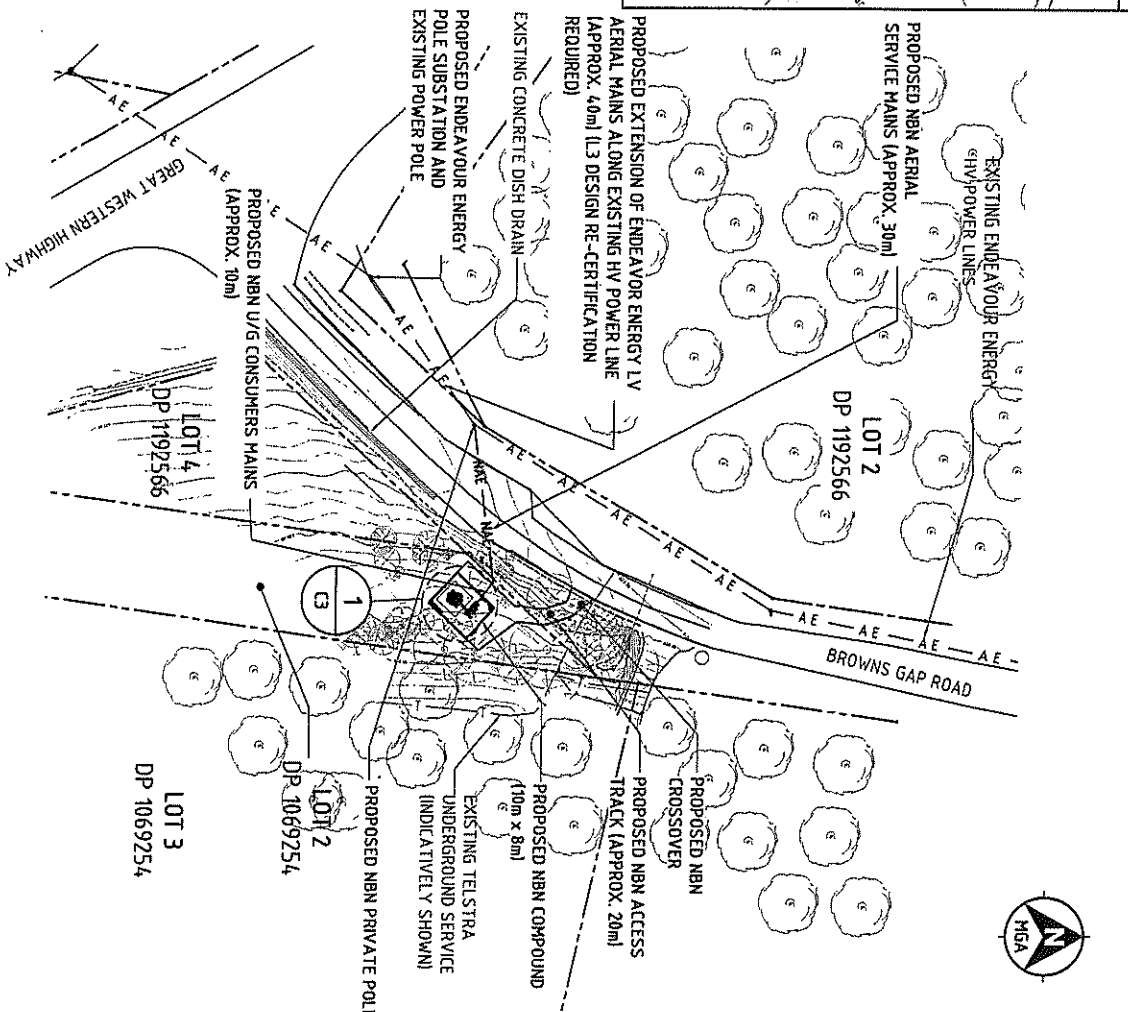

**OVERALL SITE PLAN**  
 SCALE 1:1000

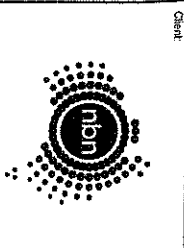
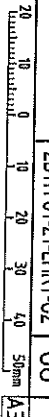

**ERICSSON**

Client: NATIONAL BROADBAND NETWORK  
 Project: SITE No 2BTH-51-21-LHRT-LITTLE HARTLEY  
 LOT 2 DP 1069254  
 608 BROWNS GAP RD & GREAT WESTERN HWY  
 LITTLE HARTLEY, NSW 2790

PRELIMINARY

- 05. DRAIN EXISTED (APPROXIMATE LOCATION)
- 06. SHEED SERVICES AND PLANNING ZONED
- 07. BULK CABINET (DIMENSIONS TO BE SIZED)
- 08. 200KV POWERED OVERHEAD LOCATION
- 09. 200KV POWERED OVERHEAD LOCATION
- 10. 200KV POWERED OVERHEAD LOCATION
- 11. 200KV POWERED OVERHEAD LOCATION
- 12. 200KV POWERED OVERHEAD LOCATION
- 13. 200KV POWERED OVERHEAD LOCATION
- 14. 200KV POWERED OVERHEAD LOCATION
- 15. 200KV POWERED OVERHEAD LOCATION
- 16. 200KV POWERED OVERHEAD LOCATION
- 17. 200KV POWERED OVERHEAD LOCATION
- 18. 200KV POWERED OVERHEAD LOCATION
- 19. 200KV POWERED OVERHEAD LOCATION
- 20. 200KV POWERED OVERHEAD LOCATION
- 21. 200KV POWERED OVERHEAD LOCATION
- 22. 200KV POWERED OVERHEAD LOCATION
- 23. 200KV POWERED OVERHEAD LOCATION
- 24. 200KV POWERED OVERHEAD LOCATION
- 25. 200KV POWERED OVERHEAD LOCATION
- 26. 200KV POWERED OVERHEAD LOCATION
- 27. 200KV POWERED OVERHEAD LOCATION
- 28. 200KV POWERED OVERHEAD LOCATION
- 29. 200KV POWERED OVERHEAD LOCATION
- 30. 200KV POWERED OVERHEAD LOCATION
- 31. 200KV POWERED OVERHEAD LOCATION
- 32. 200KV POWERED OVERHEAD LOCATION
- 33. 200KV POWERED OVERHEAD LOCATION
- 34. 200KV POWERED OVERHEAD LOCATION
- 35. 200KV POWERED OVERHEAD LOCATION
- 36. 200KV POWERED OVERHEAD LOCATION
- 37. 200KV POWERED OVERHEAD LOCATION
- 38. 200KV POWERED OVERHEAD LOCATION
- 39. 200KV POWERED OVERHEAD LOCATION
- 40. 200KV POWERED OVERHEAD LOCATION
- 41. 200KV POWERED OVERHEAD LOCATION
- 42. 200KV POWERED OVERHEAD LOCATION
- 43. 200KV POWERED OVERHEAD LOCATION
- 44. 200KV POWERED OVERHEAD LOCATION
- 45. 200KV POWERED OVERHEAD LOCATION
- 46. 200KV POWERED OVERHEAD LOCATION
- 47. 200KV POWERED OVERHEAD LOCATION
- 48. 200KV POWERED OVERHEAD LOCATION
- 49. 200KV POWERED OVERHEAD LOCATION
- 50. 200KV POWERED OVERHEAD LOCATION

**durecon**  
 Aurecon Australia Pty Ltd. ASN154 005 129 873

DESIGNER: MT  
 CHECKED: PP  
 APPROVED: CF  
 Drawing Title: OVERALL SITE PLAN  
 Drawing No: 2BTH-51-21-LHRT-C2  
 Revision: 06

**SOUTH - EAST ELEVATION**

SCALE 1:200

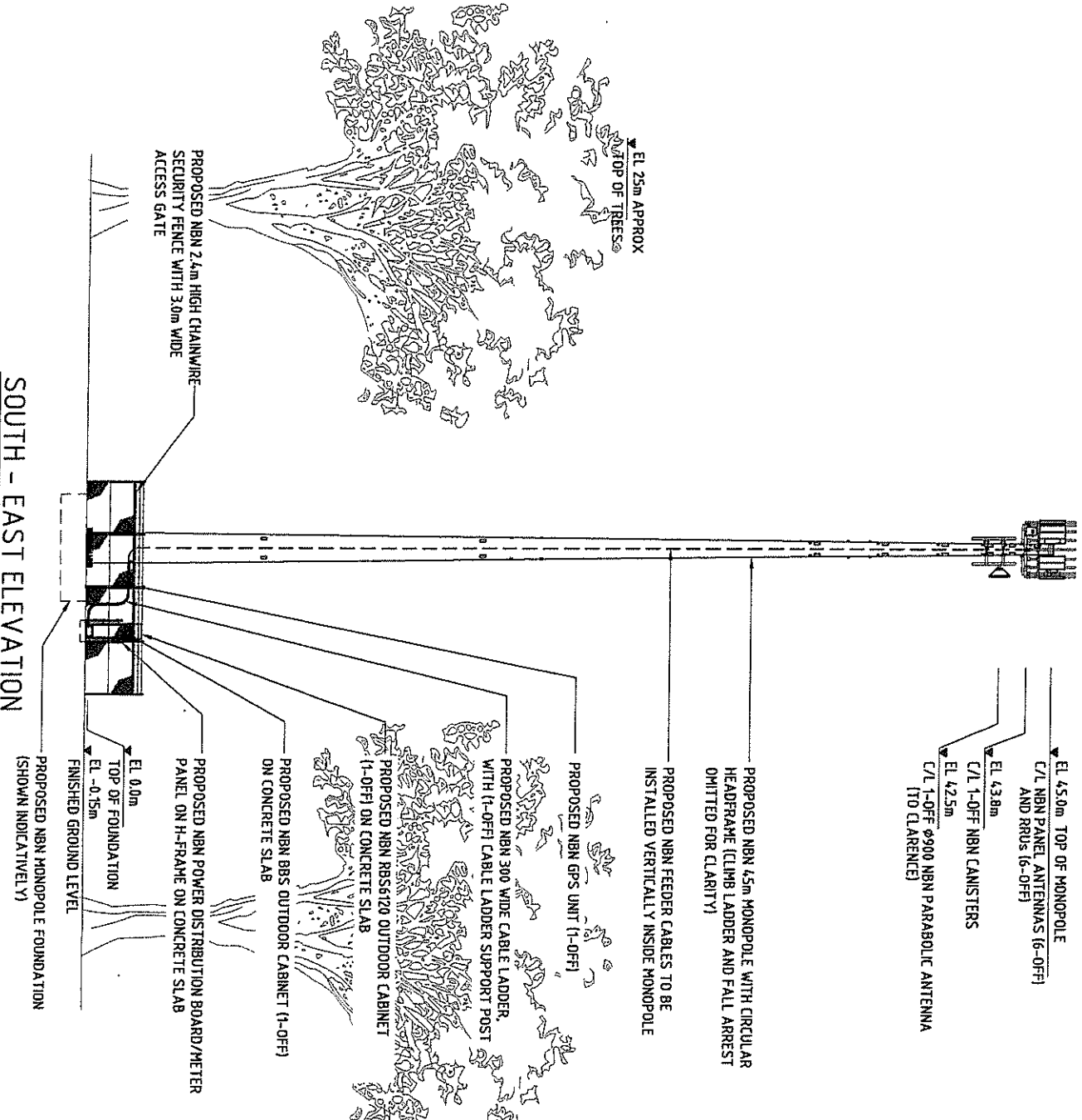

**ERICSSON**

Client:  
NBN  
Project:  
NATIONAL BROADBAND NETWORK  
SITE No. 28TH-51-21-LHRT  
LITTLE HARTLEY  
LOT 2 DP 1069254  
CNR BROWNS GAP RD & GREAT WESTERN HWY  
LITTLE HARTLEY, NSW 2790  
PRELIMINARY

DESIGNER:	MT
CHECKED:	PP
APPROVED:	CF
Drawing Title: <b>SITE ELEVATION AND DETAILS</b>	
Drawing No.	Revision
28TH-51-21-LHRT-04	06



Australian Australia Pty Ltd ABN 64 005 136 872

- 05. 2010.1 REVISED OPERATIONAL PLAN
- 06. 2010.2 NEW SITES AND PLANNING ASSESS
- 07. 2010.3 CABINET OWNED TO BUREAU
- 08. 2010.4 REVISED OPERATIONAL PLAN
- 09. 2010.5 PRELIMINARY ISSUE
- 10. 2010.6 PRELIMINARY ISSUE 10/04/11